

Modules 13000 and 13000 S

Analogical programming modules 13000 and 13000 S

Modules 13000 and 13000 S



Ref. : 13502



Ref. : 13806

Features

- Series of 40 mm dia. flush fitting analogical programming modules, intended to control all types of applications and available in 2 product families (47.5 x 60.4 x 30 mm and 42.4 x 67 x 30 mm).
- Choice of box and strap colours.
- Reduced dimensions, improved readability by an enhanced marking.
- Available in daily and weekly version with or without power reserve of 200 h.
- Programming precision of 15 minutes in daily version and 2 hours in weekly version.

Functional characteristics

13000 (47.5 x 60.4 x 30 mm) :

- Time setting in one or both directions.
- With or without clock hands.
- With or without manual pre-setting in 3 positions ON / AUTO / OFF by rotary switch.
- Outputs on Faston backside lugs.
- Power supply possible in 1.5 V.
- Various colours available for straps and boxes.
- Setting precision facilitated by clock hands.
- Ergonomy of pre-set switch, facilitating frequent use of the override function by adding an extra button.

13000 S (42.4 x 67 x 30 mm) :

- Time setting in one direction.
- Without clock hands.
- Outputs on Faston lugs on backside or on side.
- Gold- or silver-plated contact, according to type of load to be controlled.
- With or without manual pre-setting in 3 positions ON / AUTO / OFF by linear switch.

Technical characteristics

Power supply	1.1 to 24 V AC / DC or 230 V AC + 10 % - 15 %	
Frequency	50 / 60 Hz	
Absorbed power	approx. 0,5 VA	
Changeover contact	resistive load	16 A / 250 V
potential free	inductive load (cos φ = 0.6)	3 A / 250 V
Timebase	quartz crystal	
Operating precision	1 sec / 24 h	
Operating temperature	-10°C to +55°C	
Température de stockage	with power reserve	-10°C to +60°C
	without power reserve	-20°C to +70°C
Connection by Faston lugs of cross section	6,35 mm ²	
Insulation class	II	
Degree of protection	IP 20 / IK 03	
Conformity to the EN 60.730 standard	yes	

Performances indicated for an ambient temperature of 20° C

References

References	Designation	Cycle	Power reserve	Contact
13501	Module 13000S	24 h	-	16 (3) A
13502	Module 13000S	24 h	200 h	16 (3) A
13571	Module 13000S	7 d	-	16 (3) A
13572	Module 13000S	7 d	200 h	16 (3) A
13612	Module 13000S	24 h	- without override	16 (3) A
13615	Module 13000S	24 h	200 h without override	16 (3) A
13801	Module 13000	24 h	-	16 (3) A
13802	Module 13000	24 h	200 h	16 (3) A
13804	Module 13000	24 h	200 h without clock hands	16 (3) A
13806	Module 13000	24 h	- black colour	16 (3) A
13901	Module 13000	7 d	-	16 (3) A
13902	Module 13000	7 d	200 h	16 (3) A

Accessories

95581	Flush fitting clamp for model with manual override
95582	Flush fitting clamp for model without manual override
95593	Terminal cap for surface mounting
95594	Flush fitting clamp in box front side

Dimensions

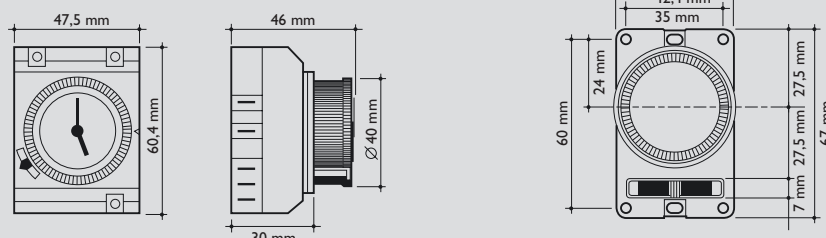

Flash Compact

Flash Compact

Time switches in surface mount box 72 x 72 mm



Ref. : 16021



Ref. : 16721

Features

- Programming by fixed segments. A red zone is unmasked by the segment when put in the ON state; in the OFF state, this red zone is masked.
- Time indication by clock hands, allowing time setting in both directions by a simple rotation. Winter/summer time corrections are easily carried out.
- Manual instantaneous pre-set control with automatic return to normal operation of the program.
- Display of contact state.
- Unpluggable time switch with stirrup terminals integrated in the box. Attachment without accessories :
 - surface mounted
 - on symmetrical rail
 - flush fitted
- 16 A changeover potential free contact.
- Choice of box and strap colours.

Functional characteristics

Daily version :

- Programming in steps of 10 min.
- Minimum interval between 2 switchings : 20 minutes.
- 72 switchings per day.
- Switching precision : 1 min. 30 sec.

Weekly version :

- Programming in steps of 1 hour.
- Minimum interval between 2 switchings : 2 hours.
- 84 switchings per week.
- Switching precision : 10 min.

Technical characteristics

Power supply	6 to 24 V AC / DC or 48 V DC / 110 - 230 V or 230 V + 10 % - 15 %	
Frequency	50 / 60 Hz	
Absorbed power	approx. 0,5 VA	
Changeover contact potential free	resistive load	16 A / 250 V
	inductive load (cos φ = 0,6)	3 A / 250 V
	incandescent lamps	1000 W / 250 V
	squirrel-cage motor	350 W / 250 V
Timebase	quartz crystal	
Operating precision	1 s / 24 h	
Operating temperature	-10°C to +50°C	
Storage temperature	-20°C to +60°C	
Connection by stirrup terminals, conductor cross section	1 to 6 mm ²	
Insulation class	II	
Degree of protection	IP 20 / IK 03	
Conformity to the EN 60.730 standard	yes	

Performances indicated for an ambient temperature of 20° C

References

230 V	6 - 24 V AC / DC	100 - 250 V AC & 48 V DC	Cycle	Power reserve	Contact
16021	16027	16302	24 h	200 h	1 x 16 (3) A
16022	16017	16301	24 h	-	1 x 16 (3) A
16721	16720	16602	7 d	200 h	1 x 16 (3) A
16722	16715	16601	7 d	-	1 x 16 (3) A

Dimensions

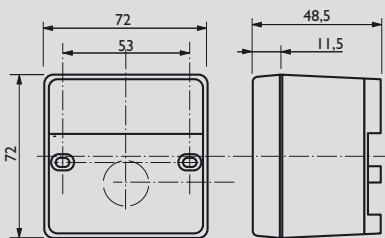

Electrical connection

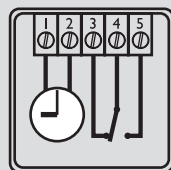

Mounting

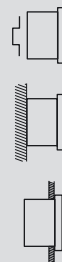

Possibility of flush fit mounting in front panel using the fastening clamp by screw (ref. : 95583) or clipped clamp (ref. : 95588). Connection by 6.35 mm flat connectors.

Flash Compact

Flash Compact

Time switches for incorporation, 72 x 72 mm



Ref. : 16001



Ref. : 16701

Features

- Programming by fixed segments. A red zone is unmasked by the segment when put in the ON state; in the OFF state, this red zone is masked.
- Time indication by clock hands, allowing time setting in both directions by a simple rotation. Winter/summer time corrections are easily carried out.
- Manual instantaneous pre-set control with automatic return to normal operation of the program.
- Display of contact state.
- Mounting :
 - flush fitting on front panel, attaching clamp from front side type BR6 or clipped clamp from back side type BR7, connection by 6.35 mm flat connector ; attachment accessories.
 - on surface mounted box (95585) ;
 - on printed circuit (95580).
- Choice of box and strap colours.

Functional characteristics

Daily version :

- Programming in steps of 10 min.
- Minimum interval between 2 switchings : 20 minutes.
- 72 switchings per day.
- Switching precision : 1 min. 30 sec.

Weekly version :

- Programming in steps of 1 hour.
- Minimum interval between 2 switchings : 2 hours.
- 84 switchings per week.
- Switching precision : 10 min.

Technical characteristics

Power supply	6 to 24 V AC / DC or 48 V DC / 110 - 230 V or 230 V + 10 % - 15 %
Frequency	50 / 60 Hz
Absorbed power	approx. 0,5 VA
Changeover contact potential free	resistive load 16 A / 250 V inductive load (cos φ = 0,6) 3 A / 250 V incandescent lamps 1000 W / 250 V squirrel-cage motor 350 W / 250 V
Timebase	quartz crystal
Operating precision	1 s / 24 h
Operating temperature	-10°C to +50°C
Storage temperature	-20°C to +60°C
Insulation class (flush fitting)	II
Degree of protection (flush fitting)	IP 20 / IK 03
Conformity to the EN 60.730 standard	yes

Performances indicated for an ambient temperature of 20° C

References

230 V	24 V AC / DC	100-250 V AC 48 V DC	Cycle	Power reserve	Attachment type	Contact
16001	16205		24 h	200 h	BR6 - BR7	16 (3) A
	16203	16009	24 h		BR6 - BR7	16 (3) A
16701	16504		7 d	200 h	BR6 - BR7	16 (3) A
	16503	16710	7 d		BR6 - BR7	16 (3) A
16061			24 h	200 h	BR7	16 (3) A
		16062	24 h		BR7	16 (3) A
16761			7 d	200 h	BR7	16 (3) A
		16762	7 d		BR7	16 (3) A

BR6 - BR7 : 2 fastening holes on front side

BR7 : without fastening holes on front side

Dimensions

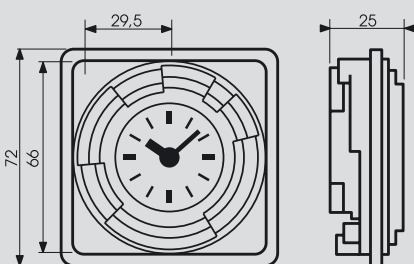

Electrical connection

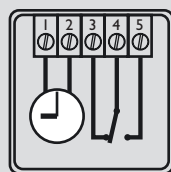

Mounting

BR6 Ref. : 95583

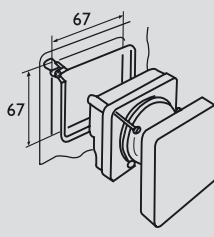

2 fastening holes present on the BR6 - BR7 versions

BR7 Ref. : 95588

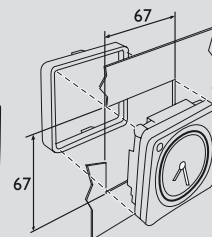

Box

Ref. : 95585

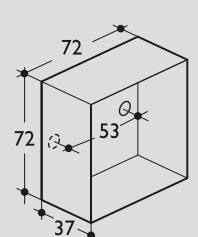

Modules 16000

Modules 16000

Analogical programming modules 16000, 1 channel



Ref. : 16090



Ref. : 16790

Features

- Series of integratable analogical programming modules.
- Dimensions 66 x 66 mm.
- Wide range of available versions
- allowing the use of these modules to control various applications in terms of environment as well as type of load.
- Choice of strap and box colours.

Functional characteristics

- Available in daily or weekly versions.
- Time setting in one or both directions.
- With or without clock hands.
- Temporary override : ON or OFF with automatic return to next set point.
- Outputs on Faston lugs located on top, bottom, left or right of the clock.
- Extra flat module : only 25 mm.
- Power supply possible in 1.5 V.
- Low consumption : large period in battery power supply.
- Various colours available for straps and boxes.
- Good readability of time and selected program.
- Setting precision facilitated by clock hands.
- Programming precision of 1 hour in weekly version.
- Integration of module by screws or clips.
- Two types of segments available.
- Also adapted for installation in the home, this module benefits from the latest technological innovations, guaranteeing it a sustainable and silent operation.

Technical characteristics

Power supply	1.1 to 2.2 V DC or 5 V DC or 48 V DC or 230 V AC + 10 % - 15 %	
Frequency	50 / 60 Hz	
Absorbed power	approx. 0,5 VA	
Changeover contact potential free	resistive load	16 A / 250 V
	inductive load (cos φ = 0.6)	3 A / 250 V
	incandescent lamps	1000 W / 250 V
	squirrel-cage motors	350 W / 250 V
Timebase	quartz crystal	
Operating precision	1 sec / 24 h	
Operating temperature	-10°C to +50°C	
Storage temperature	-20°C to +60°C	
Connection by Faston lugs of cross section	6,3 mm ²	
Insulation class	II	
Degree of protection	IP 20 / IK 03	
Conformity to the EN 60.730 standard	yes	

Performances indicated for an ambient temperature of 20° C

References

Reference in 1,5 V	Cycle	Power reserve	Contact
16090	24 h	200 h	16 (3) A
16790	24 h	200 h	16 (3) A

Dimensions

