

Contactor Replacement Coils

Coil VAC	Model	Ref.	Fig. No.
24	H2040A	A	1
120	H2040B		
240	H2040C		
277	H2040D		
480	H2040E		
24	H3040A	B	1
120	H3040B		
240	H3040C		
277	H3040D		
480	H3040E		
24	H5060A	C	2
120	H5060B		
240	H5060C		
277	H5060D		
480	H5060E		
24	H7590A	D	2
120	H7590B		
240	H7590C		
277	H7590D		
480	H7590E		
24	H120A	E	3
120	H120B		
240	H120C		
277	H120D		
480	H120E		



Fig. 1



Fig. 3



Fig. 2

Contactor Replacement Contacts

F/L Inductive Amp Range	Model	Number Of Poles
50-60	PK5060	1
75-90	PK7590	1
120	PK120	1



Contactor Auxiliary Switches

- 10 Amp @ 1/3 HP, 125 or 250 VAC.
- 1/2 Amp @ 125 VDC.
- 1/4 Amp @ 250 VDC.

Type	Model	Fig.
SPDT	H55	A
SPDT	H65	B
dual SPDT	H75	C



Fig. A



Fig. B



Fig. C

DEFINITE PURPOSE CONTACTORS (continued on next page)

Poles	F/L Inductive Amps	Locked Rotor Amps 240/480/600	Resistive Amps	Coil AC Volts	Coil VA Inrush 60 HZ	Coil VA Sealed 60 HZ	Coil VA Inrush 50 HZ	Coil VA Sealed 50 HZ	HP 120 Vac 1 PH	HP 240 Vac 1 PH	Model	Figure
1	30	150/125/100	40	24	28	5	31	6	1	2	H130A	1
				120							H130B	
				208/240							H130C	
2	40	240/200/160	50	24	28	5	31	6	2	3	H140A	2
				120							H140B	
				208/240							H140C	
2	30	150/125/100	40	24	30	6.5	33	8	2	3	H230A	3
				120							H230B	
				208/240							H230C	
2	40	240/200/160	50	24	30	6.5	33	8	2	3	H240A	4
				120							H240B	
				208/240							H240C	

3 and 4 POLE DEFINITE CONTACTORS AND REVERSING CONTACTORS pages 74-75.



Fig. 1 Single Pole

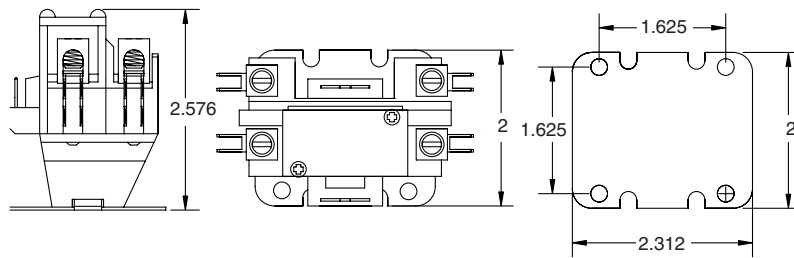

Fig. 2 Single Pole



Fig. 3 Two Pole

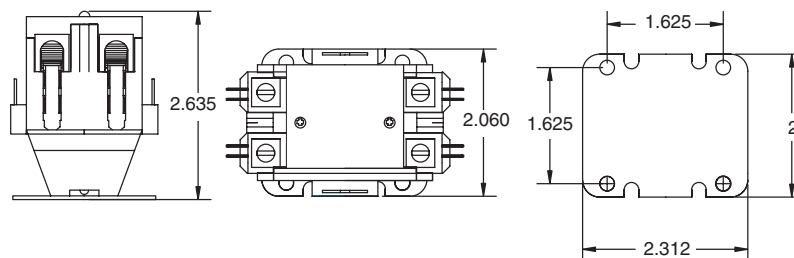

Fig. 4 Two Pole

- Fasco contactors meet specifications for devices up to 600 VAC in accordance with U.L. Bulletin No. 508, "Industrial Control Equipment."
- U.L. and CSA approved.
- Coils have Class B insulation.
- 30 Amp - Screws and quick connect terminals
- 40 Amp - Lugs and quick connect terminals



Fig. 1 Three Pole

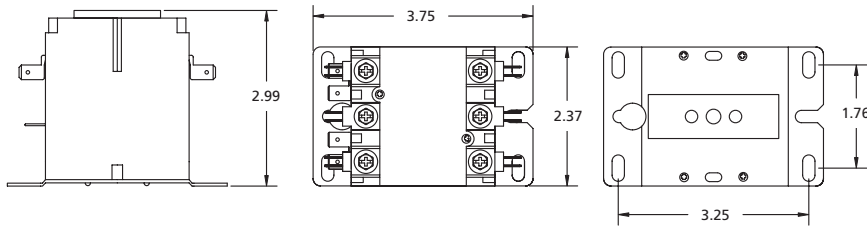

Fig. 2 Three Pole

DEFINITE PURPOSE CONTACTORS (continued from previous page)

Poles	F/L Inductive Amps	Locked Rotor Amps 240/480/600	Resistive Amps	Coil AC Volts	Coil VA Inrush 60 HZ	Coil VA Sealed 60 HZ	Coil VA Inrush 50 HZ	Coil VA Sealed 50 HZ	HP 120 Vac 1 PH	HP 208 Vac 1 PH	HP 240 Vac 1 PH	HP 208 Vac 3 PH	HP 240 Vac 3 PH	HP 480 Vac 3 PH	HP 600 Vac 3 PH
3	30	180/150/130	40	24 120 208/240	60	6	65	7.5	2		5		10	15	20
	40	240/200/160	50	24 120 208/240	60	6	65	7.5	3		7.5		10	20	25
	50	300/250/200	65	24 120 208/240	120 120 125	16	129	17.5	3	7.5	10	15	15	25	25
	60	360/300/240	75	24 120 208/240	120 120 125	16	129	17.5	5	7.5	10	25	25	30	30
	75	450/375/300	93	24 120 208/240	240	27	285	42	5	10	15	20	25	40	40
	90	540/450/360	120	24 120 208/240	240	27	285	42	7.5	15	20	25	30	50	50
4	30	180/150/130	40	24 120 208/240	60	6	65	7.5	2		5		10	15	
	40	240/200/160	50	24 120	60	6	65	7.5	3		7.5		10	20	

REVERSING CONTACTORS

Poles	F/L Inductive Amps	Locked Rotor Amps 240/480/600	Resistive Amps	Coil AC Volts	Coil VA Inrush 60 HZ	Coil VA Sealed 60 HZ	Coil VA Inrush 50 HZ	Coil VA Sealed 50 HZ	HP 120 Vac 1 PH	HP 208 Vac 1 PH	HP 240 Vac 1 PH	HP 208 Vac 3 PH	HP 240 Vac 3 PH	HP 480 Vac 3 PH	HP 600 Vac 3 PH
3	30	180/150/130	40	24 120 208/240	60	6	65	7.5	—	—	—	—	10	15	20

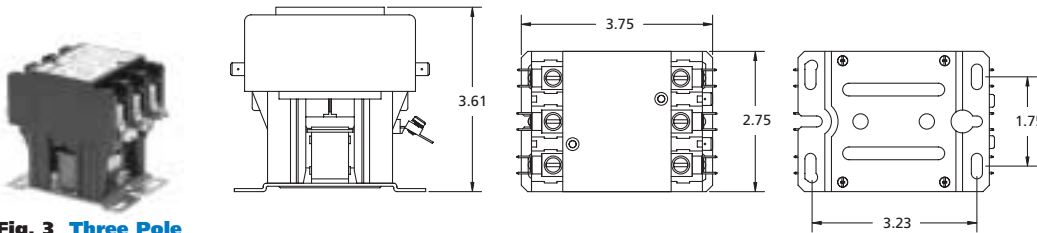

Fig. 3 Three Pole

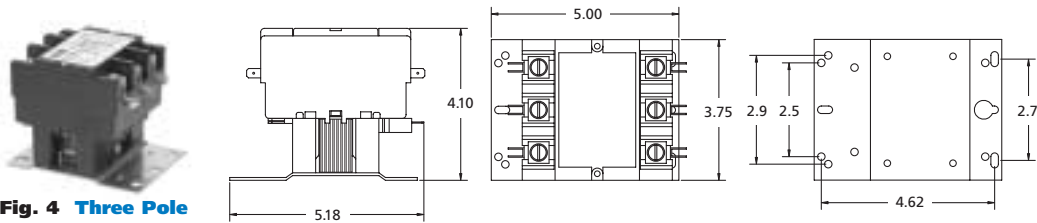

Fig. 4 Three Pole

- 30 Amp - Screws and quick connect terminals
- 40 Amp - Lugs and quick connect terminals
- 50/60 Amp - Lugs and quick connect terminals
- 75/90 Amp - Lugs and quick connect terminals
- 120 Amp - Lugs only

Model	Figure	Use Replm't. Coil Ref. Page 72	Use Opt. Aux. Switch Model Page 72	Use Repl. Contacts Model Page 72
H330A H330B H330C	1	B	H6S or H7S	—
H340A H340B H340C	2	B	H6S or H7S	—
H350A H350B H350C	3	C	H5S	PK5060
H360A H360B H360C	3	C	H5S	PK5060
H375A H375B H375C	4	D	H5S	PK7590
H390A H390B H390C	4	D	H5S	PK7590
H3120A H3120B H3120C	5	E	C5S	PK120
H430A H430B H430C	6	A	H6S OR H7S	—
H440A H440B H440C	7	A	H6S OR H7S	—

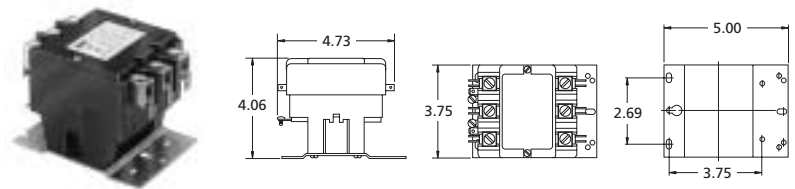

Fig. 5 Three Pole



Fig. 6 Four Pole

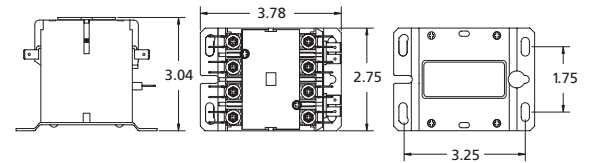

Fig. 7 Four Pole

Replaces	Model	Figure	Use Repl. Coil Ref. Page 72	Use Opt. Aux. Switch Model Page 72
3RM25A 3RM25B 3RM25C	H3R30A H3R30B H3R30C	8	B	H6S or H7S

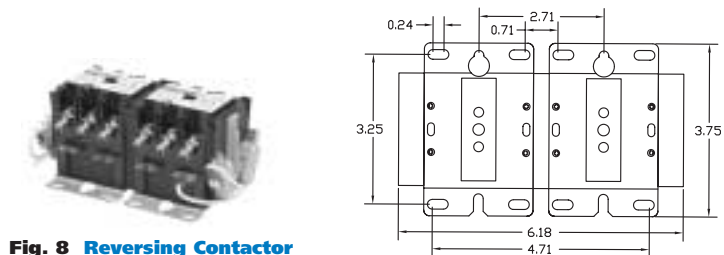

Fig. 8 Reversing Contactor