

Digital Geyser Timer : 24H/ 7 Day Timer - 230V : Geyser Efficiency



The TH-857-2 is a general purpose DIN rail time switch for daily and weekly programs, mounted in a 2-module width housing. Because of its small size, (85mm(h) x 40mm(d) x 35mm(w)), the digital timer is installed in the distribution board.

This digital timer will allow you to programme it to automatically switch your geyser/s off when not in use and automatically switch your geyser/s on to supply hot water when you need it. The digital timer has 8 on/off time settings per day, which means that you have the freedom to set your geyser/s to switch off and on 8 times a day, any day of the week.

The digital timer has a manual override feature; you can choose the geyser to be permanently ON, permanently OFF or on AUTO for the times you set the geyser to run. In case of a power outage it will not lose its set times due to a built in battery back-up system that can keep the set times for up to 200 hours.

Features

- * Latest technology COMOS Quartz Micro-Controller.
- * Digital electronics general purpose time switch with daily and weekly programs.
- * Repeat programs with 8 ON/OFF locations.
- * LED Indicator.
- * Shortest switching interval 1 minute
- * LCD indication for time-of-day, weekday & switching status.
- * NiMH rechargeable button cell back up battery for power reserve more than 100 hours after fully charged, NiMH is an environmental protection free green battery.
- * Three ways manual override operating mode for ON/AUTO/OFF by push button.
- * Simple and easy to program and operating by multi-functional keys.
- * Protected with transparent front cover.
- * Designed for full module of 35 mm size.

Technical Specifications

- * Input range: 220-250VAC
- * Output: Resistive Load: 16AMPS@230VAC Max. 3,680WATT
- * Inductive Load: 8AMPS@230VAC.
- * Back Up Battery: 1.5 VDC NiMH rechargeable battery.
- * Battery life cycle: 1,000 times from Empty to fully charge.
- * Battery reserve time: More than 200 hours after fully charge.

Geyser

DIGITAL PROGRAMMABLE TIME SWITCH



CAUTION! SAFETY PRECAUTIONS:

- Do not open time switch
- This may lead to electrical shock
- Only qualified persons may open the time switch
- Warranty will be null and void if seal is broken
- Electrical equipment should only be installed and connected by a qualified electrician.

FEATURES:

- DIN Rail Installation
- Advanced pre-setting of one week
- Latest COMS technology quartz micro controller
- Digital electronic general purpose time switch with daily and weekly programmes.
- Repeat programmes with 8 ON/8 OFF settings.
- To the minute setting accuracy
- Real time LCD display - Hour/Minute and ON/OFF/AUTO.

TECHNICAL DATA:

- Voltage limit AC 180 ~ 264V (50/60Hz)
- Hysteresis: ≤ 2 s/d (at 25°C)
- On/Off Operation: 8 On & 8 Off
- Minimum Interval: 1 minute
- Weight: Approx. 150g
- Display: LCD
- Battery Backup: 200h
- Number of circuits: 1
- Contact Rating: Resistive Load: 16A 230 VAC
Inductive Load (cos = 0.6) 4A 230 VAC
- Service life: Mechanically: 10^7 Electrically: 10^5
- Ambient Temperature: -10 - + 55°C
- Storage Temperature: -20 - + 70°C
- Power Consumption: 0.5VA

DIMENSIONS:

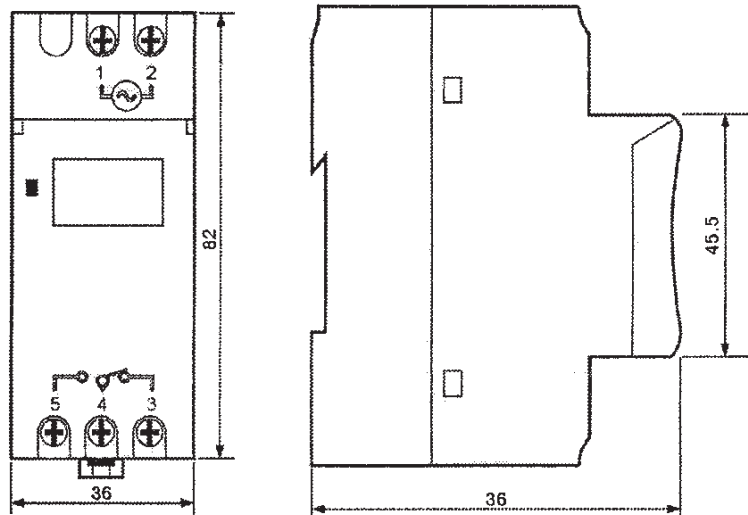

CONNECTIONS:

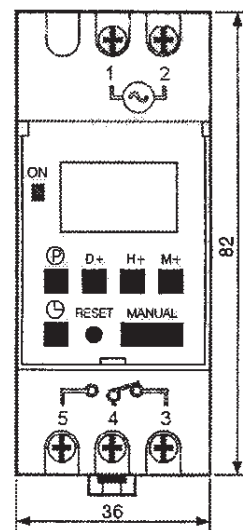

ACH15A DIGITAL PROGRAMMABLE TIME SWITCH

OPERATING INSTRUCTIONS:

- 1.) Connect the timer to mains supply (230V) and let the battery charge for 1 Hour, then press the “Reset” key to initiate the timer setting process.
- 2.) The timer will start in the 24h mode - to change this setting to the 12h mode press the ☉ key for 5 seconds, the LCD will now display AM. To return to 24h mode - repeat the the process.

3.) PROGRAMMING INSTRUCTIONS:

Step	Key	Programming
1	Press P	Setting of Programme 1 ON (Start) time (Display 1 On)
2*	Press D+	To select days of the week (If you require the same set every day, you need not press this key)
3	Press H+/M+	These keys will set hours and minutes for ON (Start) time
3a	Press MANUAL	To cancel settings
4	Press P	Setting of Programme 1 Off (Stop) time (Display 1 Off)
5	Press D+	To select days of the week (If you require the same set every day, you need not press this key)
6	Press H+/M+	These keys will set hours and minutes for OFF (Stop) time.
6a	Press MANUAL	To cancel settings
7	Repeat 2 - 6	Sets 2 through to 8 ON/OFF (Stop/Start) time settings
8**	Press ☉	Time settings are complete

* 10 different modes: 1. Mo/ 2. Tu/ 3. We/ 4. Th/ 5. Fri/ 6. Sat/ 7. Sun/ 8. Mo, Tu, We, Th, Fri/ 9. Sat, Sun/
10. Mo, Tu, We, Th, Fri, Sat, Sun.

** Should you not require 8 time settings press the ☉ key to end.

4.) SETTING THE CLOCK:

- a) Press ☉ and D+ together until correct Day is shown.
- b) Press ☉ and H+ together until correct Hour is shown.
- c) Press ☉ and M+ together until correct Minute is shown.
- d) Press “MANUAL” key to display AUTO ON or AUTO OFF. (If the Clock is ON this means AUTO ON is selected, If the Clock if OFF it will mean AUTO OFF is selected.)

5.) MANUAL (OVER-RIDE) SETTING:

To set the timer manually, press “MANUAL” key to display ON or OFF.

6.) PLEASE NOTE:

Pressing “Reset” will cancel all Programmes & Settings.

Geyser timer

